

PORTLAND POLICE BUREAU
2009 Birthingway College Clery Act Offenses

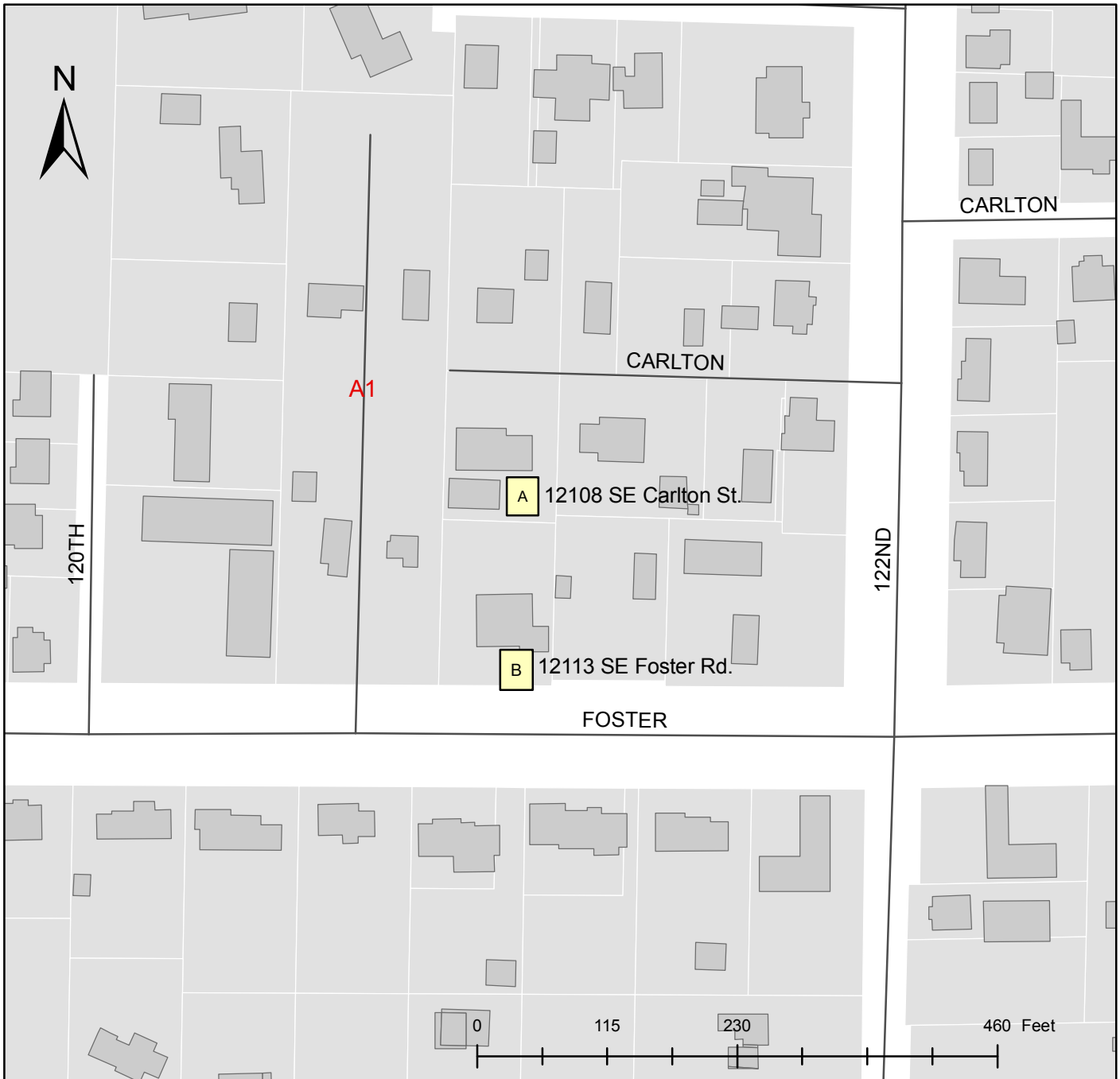

CLERY ACT OFFENSE TYPES													
ID	Address/Location	Murder	Forcible Sex Offense	Nonforcible Sex Offenses	Robbery	Aggravated Assault	Burglary	Motor Vehicle Theft	Arson	Weapons Possess	Drug Law s	Liquor Law s	Hate Crimes
A	12108 SE Carlton St.												
A1	Public Property							2					
B	12113 SE Foster Rd.												

Statistics include streets, sidewalks, intersections, and public property immediately adjacent to and accessible from campus locations. Requested by: Julia Reid, Birthingway College of Midwifery.

Prepared by: Portland Police Bureau, Strategic Services Division, July 2010. Data Source: PPDS and CAMIN2.

NOTE: Report includes only selected offense type reports received by the Portland Police Bureau from January 1, 2009 to December 31, 2009.

Clery Act Offenses: Homicide, Forcible and Non-forcible Sex Offenses, Robbery, Aggravated Assault, Burglary, Motor Vehicle Theft, Arson, Weapons, Drug Abuse, Liquor Law Violations, and Bias/hate Crimes (Includes Attempts).